

TESTING EQUIPMENT FOR THE ELECTRICAL POWER INDUSTRY

Making your job faster . safer . easier

SINGLE PHASE PROTECTION RELAY TEST SYSTEMS

MICROTEST 850sv/860 Series has been crafted specifically for secondary testing of protection relays. With test outputs of up to 200A a.c., 240V a.c. / d.c., various auxiliary voltages & a built-in timer resolution of 1ms, this unit is ideal for testing the functionality & operation times of protection relays.

This light weight equipment is designed for use in high voltage substations & industrial environments.

AC current output (Continuously adjustable)

Model	Range	No-Load Voltage (min)	Full-Load Current	Duty Cycle (ON circuit / OFF circuit)
Microtest 850sv	0 – 10 A	80 V	5 A	10 min / 15 min
	0 – 30 A	20 V	20 A	5 min / 15 min
			30 A	2 min / 15 min
			50 A	2 sec / 5 min
Microtest 860	0 – 10 A	80 V	10 A	10 min / 15 min
	0 – 25 A	25 V	25 A	5 min / 15 min
	0 – 100 A	10 V	100 A	30 sec / 5 min
			200 A	1 sec / 5 min

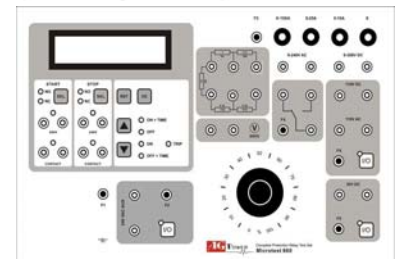
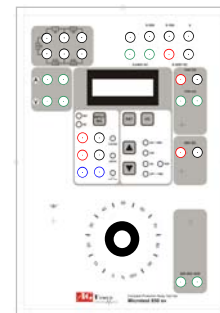

The output transformer is equipped with built-in temperature protection. The primary side is protected by miniature circuit breakers.

AC/DC voltage output (Continuously adjustable)

Range	Duty Cycle (ON circuit / OFF circuit)	Full-Load Current (max)
0-240 V AC	15 min / 30 min	1 A
0-300 V DC	15 min / 30 min	1 A

+ Voltage sources are unregulated and independently protected by re-triggerable overload fuses

AC/DC voltage output ⁺ (Fixed)

Range	Duty Cycle (ON circuit / OFF circuit)	Full-Load Current (max)
240 V AC	15 min / 30 min	0.5 A
30 V DC	15 min / 30 min	1.0 A
110 V AC 110 V DC	30 min / 30 min	0.5 A

Timer

Range	0.000 s – 999.999 s / 1ms	<ul style="list-style-type: none"> * Automatically displays trip times * Includes built in auto-reclose timer * Separate wet (Max. 250V AC/DC) and dry contacts available for triggering * Output parameters on backlit LCD
Functions	ON + Timer Start OFF ON OFF + Timer Start	

SINGLE PHASE PRIMARY INJECTION TEST SYSTEMS

PT 1000 / PT 3000 / PT 5000

The **PT Series** has been designed specifically for primary injection testing of circuit breakers, protective relay equipment & other applications that require high variable currents. This test equipment is intended for use in high voltage substations & industrial environments.

PT Model	Full-Load Current	Duty Cycle (ON circuit / OFF circuit)
PT 1000	0 - 250 A ac	60 min / 15 min
	1,000 A ac, 0-3V	5 min / 15 min
PT 3000	0 – 500 A ac	60 min / 15 min
	1,500 A ac 3,000 A ac, 0-4V	10 min / 15 min 5 sec / 15 min
PT 5000	0 – 2,000 A ac	60 min / 15 min
	5,000 A ac, 0-5V	5 min / 15 min

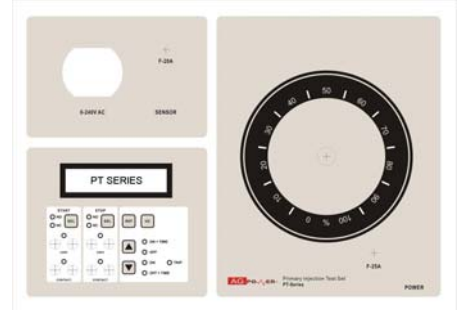

CONTACT RESISTANCE TEST

MM200A / MM600A

The **MM200A / MM600A** test system is designed to automatically measure the contact resistances of circuit breakers, disconnecting switches and busbar joints. With outputs currents of 100A, 200A, 600A and an optional factory preset current, this robust, lightweight and portable unit makes an essential tool for maintenance work.

Installed with RJ45 network port!

Operation	Duty Cycle (ON circuit / OFF circuit)	Open Circuit Voltage
100 A dc	5 min / 15 min	9 V
200 A dc	5 sec / 15 min	9 V
600 A dc	2 sec / 1 min	9 V

Measurement		
DC Current Range (1A Resolution)	Resistance Range (1 $\mu\Omega$ Resolution)	Accuracy : $\pm 1\%$ of metering
100A	0 – 50 m Ω	
200A	0 – 25 m Ω	
600A	0 – 10 m Ω	

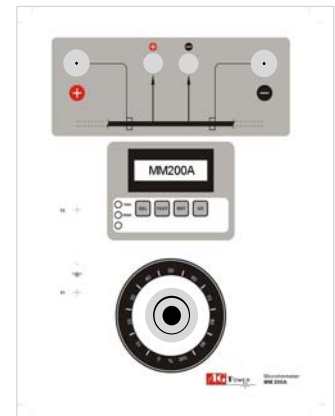

Safety	All test equipments have been designed to incorporate EN 61010-1 specifications to Safety Class 1 & Installation Category 2
Calibration	Certificate of calibration with data provided, traceable to NML standards

* Due to continuing development and improvements, specifications are subject to change without prior notice.



ASIA PACIFIC OFFICE

AGM Power Engineering Sdn. Bhd. (Co. No. 841907-U)
E-mail: agmpower@streamyx.com | Website: www.agm-power.com